



SUNSEEKER PREDATOR 52 2008 | € 390,000 EX VAT





Portside



Portside



Starboard



Stern



Cockpit



Cockpit



Cockpit



Helm Station



Helm Station



Saloon



Saloon



Saloon



Saloon



Galley



Bathroom

Deck

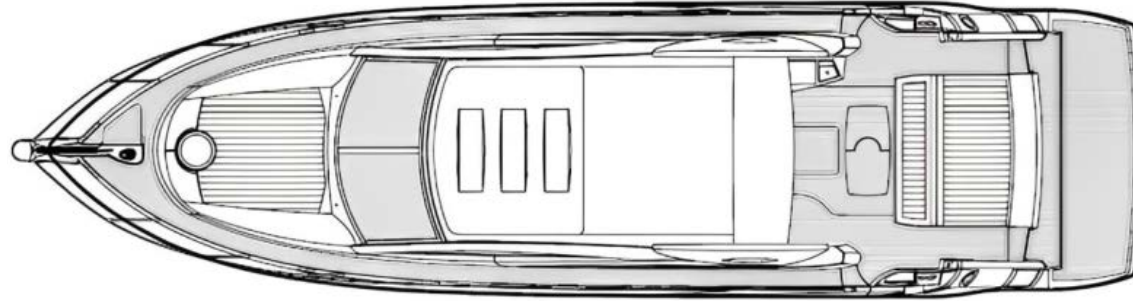

Main deck

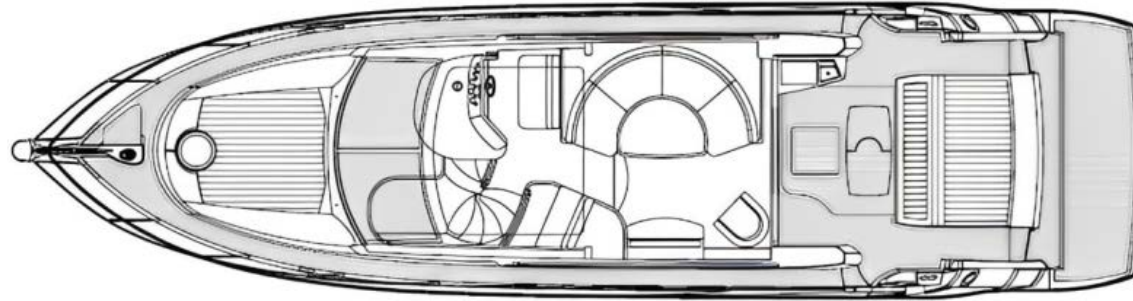

Lower deck

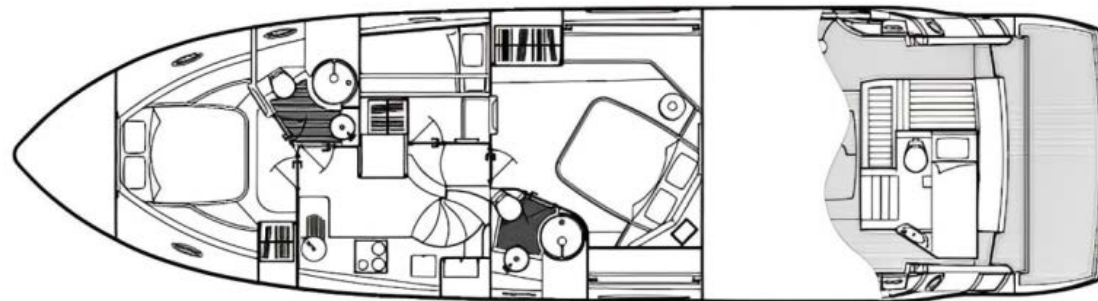

BUILDER

Sunseeker International

DIMENSIONS

- LOA: 17.02 m
- Beam: 4.63 m
- Maximum Draft: 1.26 m
- Displacement: 24800 kgs

ENGINES

- 2 x 800 CRM MAN
- Engine/Fuel Type: Diesel
- Engine hours (approx.): 1200 hours

TANKS

- Fresh Water Tanks: 625 l
- Fuel Tanks: 2140 l

ACCOMMODATION

- Cabins: 3
- Single berths: 2
- Double berths: 2

EXTRAS

- Air conditioning
- Bow thruster
- Chocks for the tender
- Tender – Williams
- Generator 11kw
- Hydraulic Gangway
- Autopilot
- GPS Plotter – Raymarine
- Radar – Raymarine
- VHF – Raymarine
- Search light
- Trim tabs
- Wood floor salon
- Awning for aft Cockpit
- Blue hull
- Ceramic HOB
- Microwave
- Refrigerator
- Battery charger
- Hot water

DISCLAIMER

All speeds, measurements, capacities, consumptions, etc. may be approximate or estimated. Specifications provided for information only. Data was obtained from sources believed to be reliable and is not guaranteed by owner or brokers. Buyer assumes the responsibility to ascertain the correctness of all data contained herein and otherwise provided and must instruct his agent and surveyors to confirm all details for accuracy prior to purchase. Subject to prior sale, price and inventory change, or withdrawal from market without notice.



1 Ha'tzedef St. Herzeliya Marina, Israel 4655201 | WhatsApp. 972-54-3997399
Tel. 972-9-9513248 | info@aquamarina.co.il | www.aquamarina.co.il